

PLANTING NOTES

1.

STAKE ALL BED LINES AND TREE LOCATIONS FOR THE LANDSCAPE ARCHITECT'S REVIEW PRIOR TO INSTALLATION. ALL PLANTING PROCEDURES ARE SUBJECT TO THE REVIEW OF THE LANDSCAPE ARCHITECT AND THE CONTRACTOR SHALL CORRECT ANY DEFICIENCIES FOUND AT NO ADDITIONAL COST TO THE OWNER.
2.

SECURE PLANT MATERIAL AS SPECIFIED ON PLANS. IN THE EVENT THAT PLANT MATERIALS SPECIFIED ARE NOT AVAILABLE, CONTACT LANDSCAPE ARCHITECT FOR APPROVED SUBSTITUTIONS. NO SUBSTITUTIONS FOR PLANT MATERIALS WILL BE ALLOWED WITHOUT PRIOR WRITTEN APPROVAL BY THE LANDSCAPE ARCHITECT.
3.

VERIFY THAT ALL PLANTING PRODUCTS, PLANT MATERIAL, AND PLANT QUANTITIES DELIVERED TO THE SITE MATCH WHAT IS INDICATED ON THE PLANS AND SPECIFICATIONS.
4.

PROTECT ALL PLANT MATERIAL DURING DELIVERY TO PREVENT DAMAGE TO ROOT BALLS, TRUNKS, BRANCHES AND THE DESICCATION OF LEAVES. PROTECT ALL PLANT MATERIAL DURING SHIPPING WITH SHADE CLOTH OR SHIP WITH ENCLOSED TRANSPORT. MAINTAIN PROTECTIONS AND HEALTH OF PLANT MATERIAL STORED ON SITE. HANDLE ALL TREES WITH NYLON STRAPS. NO CHAINS OR CABLES WILL BE ALLOWED. REMOVE UNACCEPTABLE PLANT MATERIAL IMMEDIATELY FROM THE SITE.
5.

ALL PLANT MATERIAL SHALL BE NURSERY GROWN, WELL FORMED, TRUE TO SPECIES, HARDENED OFF WITH VIGOROUS ROOT SYSTEMS, FULL CROWN AND CANOPIES, AND FREE FROM DISEASE, PESTS AND INSECTS, AND DEFECTS SUCH AS KNOTS, SUN SCALD, WINDBURN, LEAF DIS-COLORATION, IRREGULAR BRANCHING OR INJURIES.
6.

ALL ROOT BALLS SHALL CONFORM TO THE SIZE STANDARDS SET FORTH IN "AMERICAN STANDARDS FOR NURSERY STOCK".
7.

ALL PLANT MATERIAL DELIVERED TO THE SITE IS SUBJECT TO THE REVIEW OF THE LANDSCAPE ARCHITECT BEFORE, DURING AND AFTER INSTALLATION.
8.

PROVIDE PLANT SAMPLES OR PHOTOGRAPHS OF EACH PLANT SPECIFIED TO THE LANDSCAPE ARCHITECT FOR COMPLIANCE REVIEW PRIOR TO INSTALLATION.
9.

TEST FILL ALL TREE AND PLANTING PITS WITH WATER, PRIOR TO PLANTING, TO ASSURE PROPER SOIL PERCOLATION. PITS WHICH DO NOT ADEQUATELY DRAIN SHALL BE FURTHER EXCAVATED TO A DEPTH SUFFICIENT FOR DRAINAGE TO OCCUR. NO ALLOWANCES SHALL BE MADE FOR PLANT MATERIAL LOSS DUE TO IMPROPER DRAINAGE. CONTRACTOR SHALL REPLACE LOST PLANT MATERIAL WITH SAME SIZE AND SPECIES AT NO ADDITIONAL COST TO OWNER.
10.

ALL PLANT MATERIALS, INCLUDING RELOCATED PLANT MATERIAL, SHALL BE PLANTED IN A PROFESSIONAL MANNER TYPICAL TO THE INDUSTRY STANDARDS OF THE AREA TO ASSURE COMPLETE SURVIVABILITY OF ALL INSTALLED PLANT MATERIALS AS WELL AS TO PROVIDE AN AESTHETICALLY APPROVED PROJECT. CONTRACTOR SHALL REFER TO THE PLANTING DETAILS FOR MINIMUM SIZE AND WIDTH OF PLANTING PITS AND BEDS, GUYING AND STAKING, MULCHING, AND OTHER PLANTING REQUIREMENTS.
11.

ALL PLANTING AREAS SHALL BE WEED FREE PRIOR TO PLANTING INSTALLATION.
12.

REMOVE ALL PLANTING AND LANDSCAPE DEBRIS FROM THE PROJECT SITE AND SWEEP AND WASH CLEAN ALL PAVED AND FINISHED SURFACES AFFECTED BY THE LANDSCAPE INSTALLATION.

PLANTING LEGEND

	DECIDUOUS TREE SEE DETAIL 1 SHEET LZ 5.3		SOD
	SHRUBS & PERENNIALS SEE DETAIL 4 SHEET LZ 5.3		SEEDED TURF WHERE NECESSARY ON DISTURBED SOILS

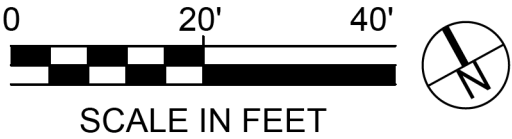

MKSK

200 SOUTH MERIDIAN STREET, SUITE 450
INDIANAPOLIS, IN 46225
PHONE: (317) 423-9600

NOT FOR
CONSTRUCTION

RECOMMENDED
FOR APPROVAL _____ X/XX/XXXX
DESIGN ENGINEER DATE

DESIGNED: EL 2/21/2020 DRAWN: JD 2/21/2020

CHECKED: MB 2/21/2020 CHECKED: MB 2/21/2020

TOWN OF CLARKSVILLE

LP 2.1 - PLANTING PLAN

HORIZONTAL SCALE	BRIDGE FILE	
1" = 20'	N/A	
VERTICAL SCALE	DESIGNATION	
N/A	1700725	
SURVEY BOOK	SHEETS	
Electronic	30	of 83
CONTRACT	PROJECT	
R-40289	1700725	

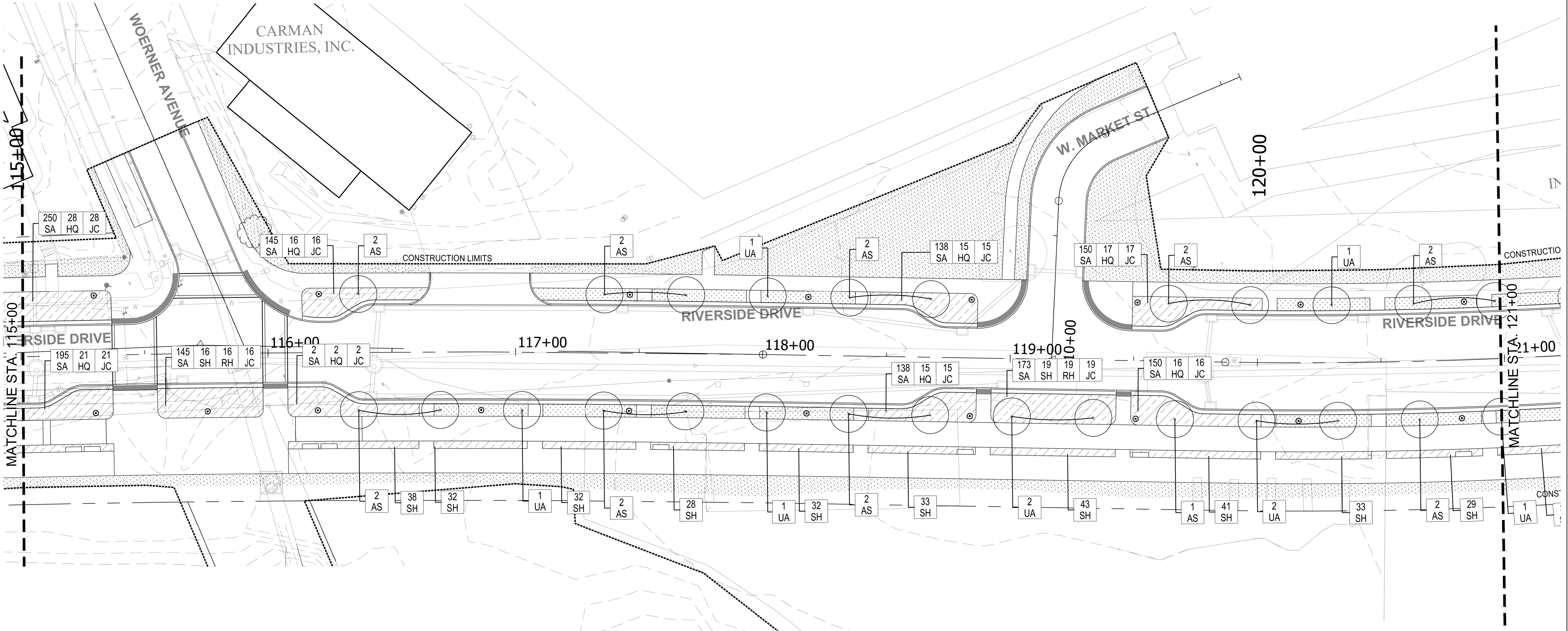

PLANTING NOTES

1.

STAKE ALL BED LINES AND TREE LOCATIONS FOR THE LANDSCAPE ARCHITECT'S REVIEW PRIOR TO INSTALLATION. ALL PLANTING PROCEDURES ARE SUBJECT TO THE REVIEW OF THE LANDSCAPE ARCHITECT AND THE CONTRACTOR SHALL CORRECT ANY DEFICIENCIES FOUND AT NO ADDITIONAL COST TO THE OWNER.
2.

SECURE PLANT MATERIAL AS SPECIFIED ON PLANS. IN THE EVENT THAT PLANT MATERIALS SPECIFIED ARE NOT AVAILABLE, CONTACT LANDSCAPE ARCHITECT FOR APPROVED SUBSTITUTIONS. NO SUBSTITUTIONS FOR PLANT MATERIALS WILL BE ALLOWED WITHOUT PRIOR WRITTEN APPROVAL BY THE LANDSCAPE ARCHITECT.
3.

VERIFY THAT ALL PLANTING PRODUCTS, PLANT MATERIAL, AND PLANT QUANTITIES DELIVERED TO THE SITE MATCH WHAT IS INDICATED ON THE PLANS AND SPECIFICATIONS.
4.

PROTECT ALL PLANT MATERIAL DURING DELIVERY TO PREVENT DAMAGE TO ROOT BALLS, TRUNKS, BRANCHES AND THE DESICCATION OF LEAVES. PROTECT ALL PLANT MATERIAL DURING SHIPPING WITH SHADE CLOTH OR SHIP WITH ENCLOSED TRANSPORT. MAINTAIN PROTECTIONS AND HEALTH OF PLANT MATERIAL STORED ON SITE. HANDLE ALL TREES WITH NYLON STRAPS. NO CHAINS OR CABLES WILL BE ALLOWED. REMOVE UNACCEPTABLE PLANT MATERIAL IMMEDIATELY FROM THE SITE.
5.

ALL PLANT MATERIAL SHALL BE NURSERY GROWN, WELL FORMED, TRUE TO SPECIES, HARDENED OFF WITH VIGOROUS ROOT SYSTEMS, FULL CROWN AND CANOPIES, AND FREE FROM DISEASE, PESTS AND INSECTS, AND DEFECTS SUCH AS KNOTS, SUN SCALD, WINDBURN, LEAF DIS-COLORATION, IRREGULAR BRANCHING OR INJURIES.
6.

ALL ROOT BALLS SHALL CONFORM TO THE SIZE STANDARDS SET FORTH IN "AMERICAN STANDARDS FOR NURSERY STOCK".
7.

ALL PLANT MATERIAL DELIVERED TO THE SITE IS SUBJECT TO THE REVIEW OF THE LANDSCAPE ARCHITECT BEFORE, DURING AND AFTER INSTALLATION.
8.

PROVIDE PLANT SAMPLES OR PHOTOGRAPHS OF EACH PLANT SPECIFIED TO THE LANDSCAPE ARCHITECT FOR COMPLIANCE REVIEW PRIOR TO INSTALLATION.
9.

TEST FILL ALL TREE AND PLANTING PITS WITH WATER, PRIOR TO PLANTING, TO ASSURE PROPER SOIL PERCOLATION. PITS WHICH DO NOT ADEQUATELY DRAIN SHALL BE FURTHER EXCAVATED TO A DEPTH SUFFICIENT FOR DRAINAGE TO OCCUR. NO ALLOWANCES SHALL BE MADE FOR PLANT MATERIAL LOSS DUE TO IMPROPER DRAINAGE. CONTRACTOR SHALL REPLACE LOST PLANT MATERIAL WITH SAME SIZE AND SPECIES AT NO ADDITIONAL COST TO OWNER.
10.

ALL PLANT MATERIALS, INCLUDING RELOCATED PLANT MATERIAL, SHALL BE PLANTED IN A PROFESSIONAL MANNER TYPICAL TO THE INDUSTRY STANDARDS OF THE AREA TO ASSURE COMPLETE SURVIVABILITY OF ALL INSTALLED PLANT MATERIALS AS WELL AS TO PROVIDE AN AESTHETICALLY APPROVED PROJECT. CONTRACTOR SHALL REFER TO THE PLANTING DETAILS FOR MINIMUM SIZE AND WIDTH OF PLANTING PITS AND BEDS, GUYING AND STAKING, MULCHING, AND OTHER PLANTING REQUIREMENTS.
11.

ALL PLANTING AREAS SHALL BE WEED FREE PRIOR TO PLANTING INSTALLATION.
12.

REMOVE ALL PLANTING AND LANDSCAPE DEBRIS FROM THE PROJECT SITE AND SWEEP AND WASH CLEAN ALL PAVED AND FINISHED SURFACES AFFECTED BY THE LANDSCAPE INSTALLATION.

PLANTING LEGEND

	DECIDUOUS TREE SEE DETAIL 1 SHEET LZ 5.3		SOD
	SHRUBS & PERENNIALS SEE DETAIL 4 SHEET LZ 5.3		SEEDED TURF WHERE NECESSARY ON DISTURBED SOILS

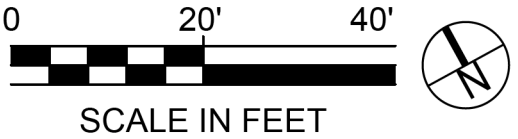

MKSK

200 SOUTH MERIDIAN STREET, SUITE 450
INDIANAPOLIS, IN 46225
PHONE: (317) 423-9600

NOT FOR
CONSTRUCTION

RECOMMENDED
FOR APPROVAL _____ X/XX/XXXX
DESIGN ENGINEER DATE

DESIGNED: EL 2/21/2020 DRAWN: JD 2/21/2020

CHECKED: MB 2/21/2020 CHECKED: MB 2/21/2020

TOWN OF CLARKSVILLE

LP 2.2 - PLANTING PLAN

HORIZONTAL SCALE	BRIDGE FILE	
1" = 20'	N/A	
VERTICAL SCALE	DESIGNATION	
N/A	1700725	
SURVEY BOOK	SHEETS	
Electronic	31	of 83
CONTRACT	PROJECT	
R-40289	1700725	

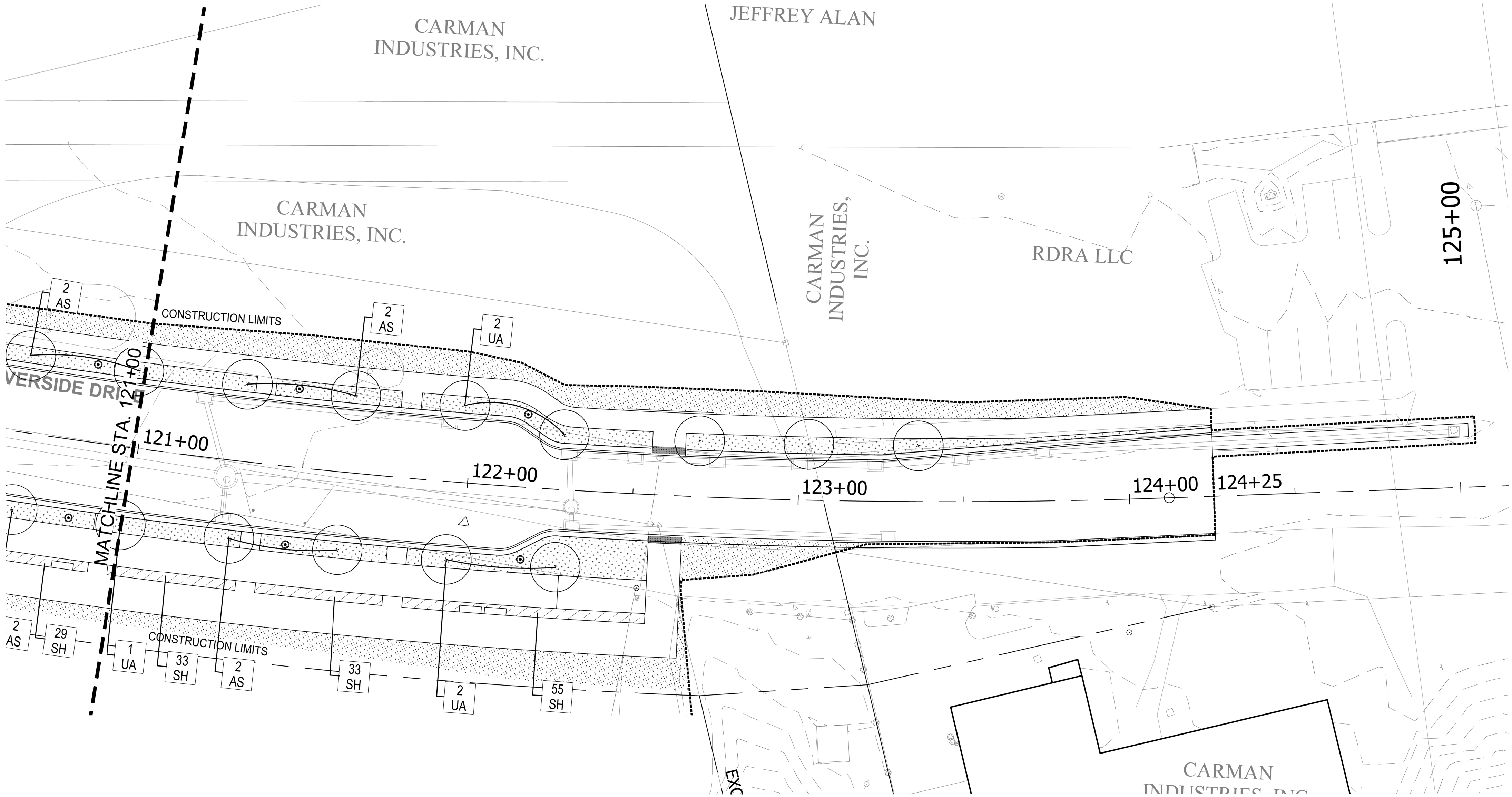

PLANTING NOTES

1.

STAKE ALL BED LINES AND TREE LOCATIONS FOR THE LANDSCAPE ARCHITECT'S REVIEW PRIOR TO INSTALLATION. ALL PLANTING PROCEDURES ARE SUBJECT TO THE REVIEW OF THE LANDSCAPE ARCHITECT AND THE CONTRACTOR SHALL CORRECT ANY DEFICIENCIES FOUND AT NO ADDITIONAL COST TO THE OWNER.
2.

SECURE PLANT MATERIAL AS SPECIFIED ON PLANS. IN THE EVENT THAT PLANT MATERIALS SPECIFIED ARE NOT AVAILABLE, CONTACT LANDSCAPE ARCHITECT FOR APPROVED SUBSTITUTIONS. NO SUBSTITUTIONS FOR PLANT MATERIALS WILL BE ALLOWED WITHOUT PRIOR WRITTEN APPROVAL BY THE LANDSCAPE ARCHITECT.
3.

VERIFY THAT ALL PLANTING PRODUCTS, PLANT MATERIAL, AND PLANT QUANTITIES DELIVERED TO THE SITE MATCH WHAT IS INDICATED ON THE PLANS AND SPECIFICATIONS.
4.

PROTECT ALL PLANT MATERIAL DURING DELIVERY TO PREVENT DAMAGE TO ROOT BALLS, TRUNKS, BRANCHES AND THE DESICCATION OF LEAVES. PROTECT ALL PLANT MATERIAL DURING SHIPPING WITH SHADE CLOTH OR SHIP WITH ENCLOSED TRANSPORT. MAINTAIN PROTECTIONS AND HEALTH OF PLANT MATERIAL STORED ON SITE. HANDLE ALL TREES WITH NYLON STRAPS. NO CHAINS OR CABLES WILL BE ALLOWED. REMOVE UNACCEPTABLE PLANT MATERIAL IMMEDIATELY FROM THE SITE.
5.

ALL PLANT MATERIAL SHALL BE NURSERY GROWN, WELL FORMED, TRUE TO SPECIES, HARDENED OFF WITH VIGOROUS ROOT SYSTEMS, FULL CROWN AND CANOPIES, AND FREE FROM DISEASE, PESTS AND INSECTS, AND DEFECTS SUCH AS KNOTS, SUN SCALD, WINDBURN, LEAF DIS-COLORATION, IRREGULAR BRANCHING OR INJURIES.
6.

ALL ROOT BALLS SHALL CONFORM TO THE SIZE STANDARDS SET FORTH IN "AMERICAN STANDARDS FOR NURSERY STOCK".
7.

ALL PLANT MATERIAL DELIVERED TO THE SITE IS SUBJECT TO THE REVIEW OF THE LANDSCAPE ARCHITECT BEFORE, DURING AND AFTER INSTALLATION.
8.

PROVIDE PLANT SAMPLES OR PHOTOGRAPHS OF EACH PLANT SPECIFIED TO THE LANDSCAPE ARCHITECT FOR COMPLIANCE REVIEW PRIOR TO INSTALLATION.
9.

TEST FILL ALL TREE AND PLANTING PITS WITH WATER, PRIOR TO PLANTING, TO ASSURE PROPER SOIL PERCOLATION. PITS WHICH DO NOT ADEQUATELY DRAIN SHALL BE FURTHER EXCAVATED TO A DEPTH SUFFICIENT FOR DRAINAGE TO OCCUR. NO ALLOWANCES SHALL BE MADE FOR PLANT MATERIAL LOSS DUE TO IMPROPER DRAINAGE. CONTRACTOR SHALL REPLACE LOST PLANT MATERIAL WITH SAME SIZE AND SPECIES AT NO ADDITIONAL COST TO OWNER.
10.

ALL PLANT MATERIALS, INCLUDING RELOCATED PLANT MATERIAL, SHALL BE PLANTED IN A PROFESSIONAL MANNER TYPICAL TO THE INDUSTRY STANDARDS OF THE AREA TO ASSURE COMPLETE SURVIVABILITY OF ALL INSTALLED PLANT MATERIALS AS WELL AS TO PROVIDE AN AESTHETICALLY APPROVED PROJECT. CONTRACTOR SHALL REFER TO THE PLANTING DETAILS FOR MINIMUM SIZE AND WIDTH OF PLANTING PITS AND BEDS, GUYING AND STAKING, MULCHING, AND OTHER PLANTING REQUIREMENTS.
11.

ALL PLANTING AREAS SHALL BE WEED FREE PRIOR TO PLANTING INSTALLATION.
12.

REMOVE ALL PLANTING AND LANDSCAPE DEBRIS FROM THE PROJECT SITE AND SWEEP AND WASH CLEAN ALL PAVED AND FINISHED SURFACES AFFECTED BY THE LANDSCAPE INSTALLATION.

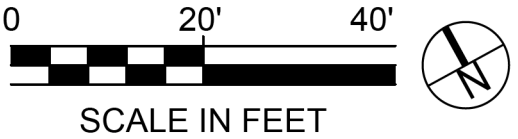

PLANTING LEGEND

	DECIDUOUS TREE SEE DETAIL 1 SHEET LZ 5.3		SOD
	SHRUBS & PERENNIALS SEE DETAIL 4 SHEET LZ 5.3		SEEDED TURF WHERE NECESSARY ON DISTURBED SOILS

MKSK

200 SOUTH MERIDIAN STREET, SUITE 450
INDIANAPOLIS, IN 46225
PHONE: (317) 423-9600

NOT FOR
CONSTRUCTION

RECOMMENDED
FOR APPROVAL _____ X/XX/XXXX
DESIGN ENGINEER DATE

DESIGNED: EL 2/21/2020 DRAWN: JD 2/21/2020

CHECKED: MB 2/21/2020 CHECKED: MB 2/21/2020

TOWN OF CLARKSVILLE

LP 2.3 - PLANTING PLAN

HORIZONTAL SCALE	BRIDGE FILE	
1" = 20'	N/A	
VERTICAL SCALE	DESIGNATION	
N/A	1700725	
SURVEY BOOK	SHEETS	
Electronic	32	of 83
CONTRACT	PROJECT	
R-40289	1700725	

MARATHON ASHLAND
PETROLEUM LLC

105+00

104+00

106+00

107+00

108+00

109+00

CONSTRUCTION LIMITS

WATCHLINE STA 109+00

CONSTRUCTION LIMITS

MARATHON ASHLAND
PETROLEUM LLC

NOT FOR
CONSTRUCTION

LS 3.0 - SOIL PLAN

O:\Projects\2018\n18901-Clarksville Riverside Drive\CAD\Current\18901_LS.dwg

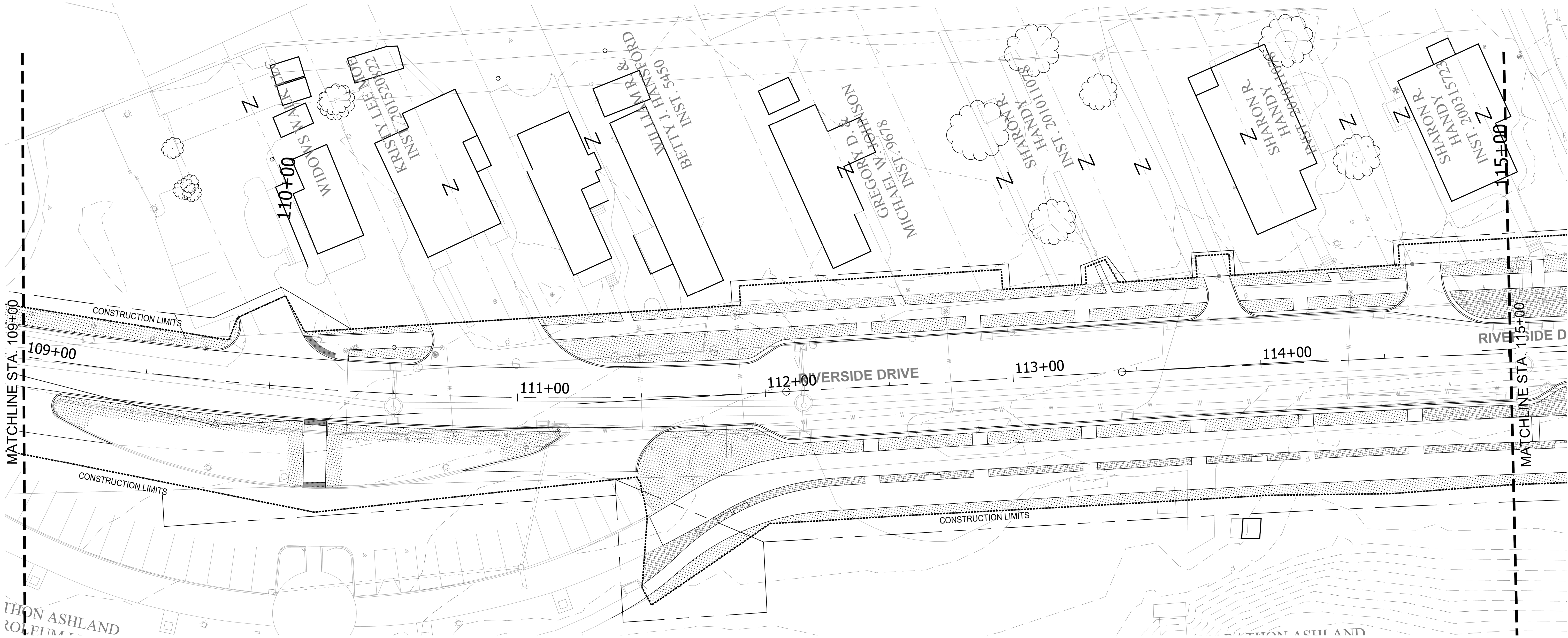

SOILS NOTES

- 1. DO NOT FILL OVER EXISTING TREE ROOT ZONES.
- 2. PREPARE TRANSITION ZONE ABOVE SUBSOIL IN TURF BED AND TREE PLANTING AREAS AS DESCRIBED IN THE SPECIFICATIONS.
- 3. ALL AREAS WITHIN GRADING LIMITS OR DISTURBED BY CONSTRUCTION ACTIVITES AND NOT SHOWN TO RECEIVE IMPORTED TOPSOIL ON THIS PLAN SHALL RECEIVE CLEAN AMENDED TOPSOIL AND BE SEEDED PER THE SPECIFICATIONS.
- 4. TOPSOIL DEPTH INDICATED IS THE FINAL DEPTH REQUIRED. COMPENSATE FOR SETTLING AND COMPACTION AS NECESSARY.
- 5. OVEREXCAVATE TO DEPTH NECESSARY TO PROVIDE REQUIRED DEPTH OF TOPSOIL.
- 6. REFER TO THE SPECIFICATIONS FOR MORE INFORMATION ON SOIL AMENDMENTS AND SOIL MIXES.
- 7. REFER TO CIVIL DRAWINGS FOR EXISTING SURVEY INFORMATION.

SOILS LEGEND

SYMBOL	SOIL TYPE	
	PLANTING SOIL 18" PLANTING MIX	SEE DETAIL 2 SHEET LZ 5.3
	LAWN PLANTING SOIL 6" PLANTING MIX	SEE DETAIL 3 SHEET LZ 5.3

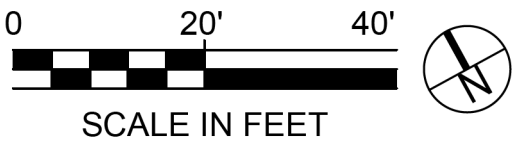

MKSK

200 SOUTH MERIDIAN STREET, SUITE 450
INDIANAPOLIS, IN 46225
PHONE: (317) 423-9600

NOT FOR
CONSTRUCTION

RECOMMENDED FOR APPROVAL _____ X/XX/XXXXX
DESIGN ENGINEER DATE

DESIGNED: EL 2/21/2020 DRAWN: JD 2/21/2020

CHECKED: MB 2/21/2020 CHECKED: MB 2/21/2020

TOWN OF CLARKSVILLE

LS 3.1 - SOIL PLAN

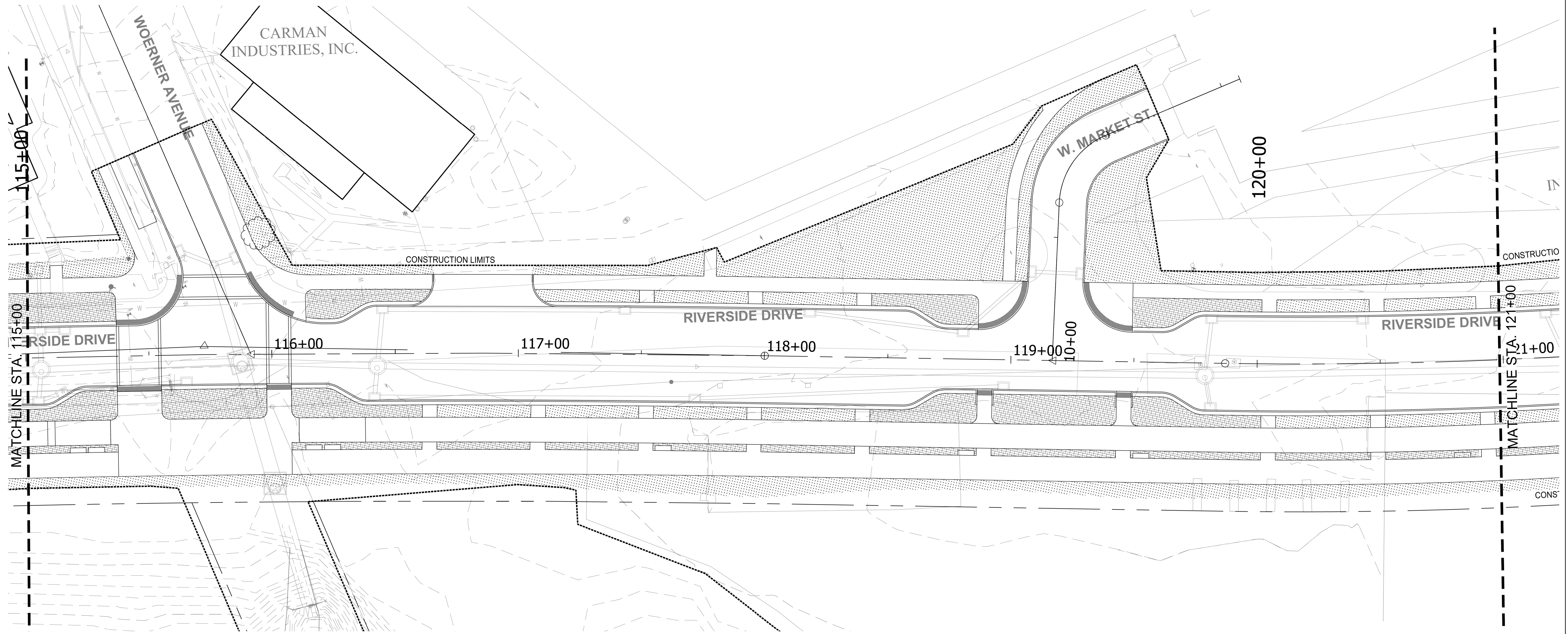

HORIZONTAL SCALE	BRIDGE FILE	
1" = 20'	N/A	
VERTICAL SCALE	DESIGNATION	
N/A	1700725	
SURVEY BOOK	SHEETS	
Electronic	34	of 83
CONTRACT	PROJECT	
R-40289	1700725	



SOILS NOTES

1. DO NOT FILL OVER EXISTING TREE ROOT ZONES.
2. PREPARE TRANSITION ZONE ABOVE SUBSOIL IN TURF BED AND TREE PLANTING AREAS AS DESCRIBED IN THE SPECIFICATIONS.
3. ALL AREAS WITHIN GRADING LIMITS OR DISTURBED BY CONSTRUCTION ACTIVITIES AND NOT SHOWN TO RECEIVE IMPORTED TOPSOIL ON THIS PLAN SHALL RECEIVE CLEAN AMENDED TOPSOIL AND BE SEEDDED PER THE SPECIFICATIONS.
4. TOPSOIL DEPTH INDICATED IS THE FINAL DEPTH REQUIRED. COMPENSATE FOR SETTLING AND COMPACTION AS NECESSARY.
5. OVEREXCAVATE TO DEPTH NECESSARY TO PROVIDE REQUIRED DEPTH OF TOPSOIL.
6. REFER TO THE SPECIFICATIONS FOR MORE INFORMATION ON SOIL AMENDMENTS AND SOIL MIXES.
7. REFER TO CIVIL DRAWINGS FOR EXISTING SURVEY INFORMATION.

SOILS LEGEND

SYMBOL	SOIL TYPE	
	PLANTING SOIL 18" PLANTING MIX	SEE DETAIL 2 SHEET LZ 5.3
	LAWN PLANTING SOIL 6" PLANTING MIX	SEE DETAIL 3 SHEET LZ 5.3

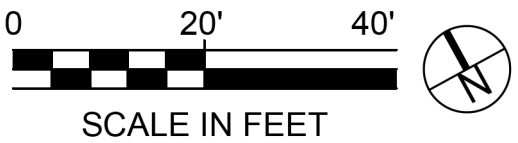

<div><div>MKSK</div><div>200 SOUTH MERIDIAN STREET, SUITE 450 INDIANAPOLIS, IN 46225 PHONE: (317) 423-9600</div></div>	<div>NOT FOR CONSTRUCTION</div>	<div>RECOMMENDED FOR APPROVAL</div> <div>DESIGN ENGINEER</div> <div>X/XX/XXXX DATE</div>	<div>TOWN OF CLARKSVILLE</div>	<div>HORIZONTAL SCALE</div> <div>1" = 20'</div> <div>VERTICAL SCALE</div> <div>N/A</div>	<div>BRIDGE FILE</div> <div>N/A</div> <div>DESIGNATION</div> <div>1700725</div>
		<div>DESIGNED: EL 2/21/2020</div> <div>DRAWN: JD 2/21/2020</div>	<div>LS 3.2 - SOIL PLAN</div>	<div>SURVEY BOOK</div> <div>Electronic</div> <div>CONTRACT</div> <div>R-40289</div>	<div>SHEETS</div> <div>35 of 83</div> <div>PROJECT</div> <div>1700725</div>
		<div>CHECKED: MB 2/21/2020</div> <div>CHECKED: MB 2/21/2020</div>			

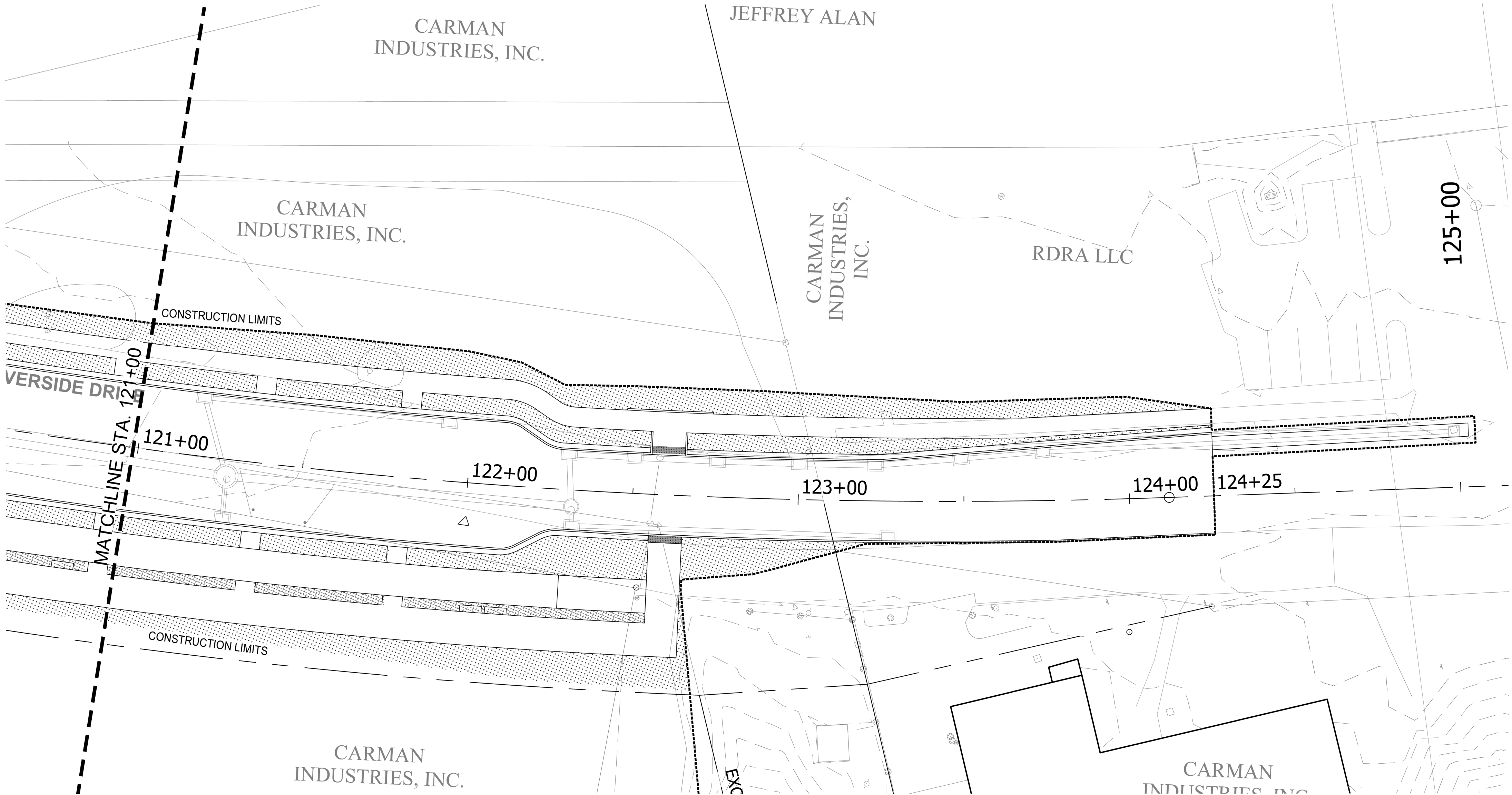

SOILS NOTES

- 1. DO NOT FILL OVER EXISTING TREE ROOT ZONES.
- 2. PREPARE TRANSITION ZONE ABOVE SUBSOIL IN TURF BED AND TREE PLANTING AREAS AS DESCRIBED IN THE SPECIFICATIONS.
- 3. ALL AREAS WITHIN GRADING LIMITS OR DISTURBED BY CONSTRUCTION ACTIVITES AND NOT SHOWN TO RECEIVE IMPORTED TOPSOIL ON THIS PLAN SHALL RECEIVE CLEAN AMENDED TOPSOIL AND BE SEEDED PER THE SPECIFICATIONS.
- 4. TOPSOIL DEPTH INDICATED IS THE FINAL DEPTH REQUIRED. COMPENSATE FOR SETTLING AND COMPACTION AS NECESSARY.
- 5. OVEREXCAVATE TO DEPTH NECESSARY TO PROVIDE REQUIRED DEPTH OF TOPSOIL.
- 6. REFER TO THE SPECIFICATIONS FOR MORE INFORMATION ON SOIL AMENDMENTS AND SOIL MIXES.
- 7. REFER TO CIVIL DRAWINGS FOR EXISTING SURVEY INFORMATION.

SOILS LEGEND

SYMBOL	SOIL TYPE	
	PLANTING SOIL 18" PLANTING MIX	SEE DETAIL 2 SHEET LZ 5.3
	LAWN PLANTING SOIL 6" PLANTING MIX	SEE DETAIL 3 SHEET LZ 5.3

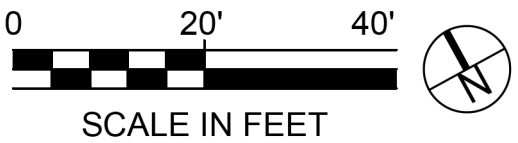

MARATHON ASHLAND
PETROLEUM LLC

105+00

104+00

106+00

107+00

108+00

109+00

CONSTRUCTION LIMITS

CONSTRUCTION LIMITS

MARATHON ASHLAND
PETROLEUM LLC

LAYOUT LEGEND



ALIGN



CONSTRUCTION JOINT
SEE DETAIL 2, SHEET LZ 5.0



CONTROL JOINT
SEE DETAIL 3, SHEET LZ 5.0

CODED NOTES

1 REFER TO CIVIL SHEETS FOR CURB RAMP LAYOUT.

LAYOUT NOTES

- ALL DIMENSIONS SHOWN ARE IN FEET AND INCHES UNLESS OTHERWISE NOTED.
- DO NOT SCALE DRAWINGS. UTILIZE DIMENSIONS INDICATED ON THE PLANS.
- ALL DIMENSIONS ARE TO THE EDGE OF PAVEMENT, FACE OF WALL, OR FACE OF CURB UNLESS OTHERWISE NOTED.
- WALKWAYS AND HARDSCAPE ELEMENTS INDICATED AS CURVILINEAR SHALL HAVE SMOOTH CONTINUOUS CURVES.
- UNLESS INDICATED OTHERWISE, ALL WALKWAYS ABUTT AT 90 DEGREE ANGLES.
- ALL CONCRETE SCORING SHALL BE PARALLEL, PERPENDICULAR OR TANGENT TO ADJACENT IMPROVEMENTS UNLESS OTHERWISE NOTED.
- LAYOUT ALL CONSTRUCTION LINES AND VERIFY LAYOUT WITH THE OWNER'S REPRESENTATIVE PRIOR TO BEGINNING ANY CONSTRUCTION WORK.
- PROVIDE ISOLATION JOINTS WHERE CONCRETE PAVING OR PAVING BASE MEETS A FIXED STRUCTURE (EXISTING OR PROPOSED).
- PROVIDE FLUSH CONDITIONS AT JUNCTURE OF ALL WALKWAYS AND DOOR THRESHOLDS.

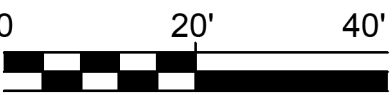

SCALE IN FEET

MKSK

200 SOUTH MERIDIAN STREET, SUITE 450
INDIANAPOLIS, IN 46225
PHONE: (317) 423-9600

NOT FOR
CONSTRUCTION

RECOMMENDED FOR APPROVAL _____ X/XX/XXXX
DATE
DESIGN ENGINEER

DESIGNED: EL 3/19/2020 DRAWN: JD 2/21/2020

CHECKED: MB 2/21/2020 CHECKED: MB 2/21/2020

TOWN OF CLARKSVILLE

LL 4.0 - LAYOUT PLAN

HORIZONTAL SCALE

1" = 20'

VERTICAL SCALE

N/A

SURVEY BOOK

Electronic

CONTRACT

R-40289

BRIDGE FILE

N/A

DESIGNATION

1700725

SHEETS

37

of

83

PROJECT

1700725

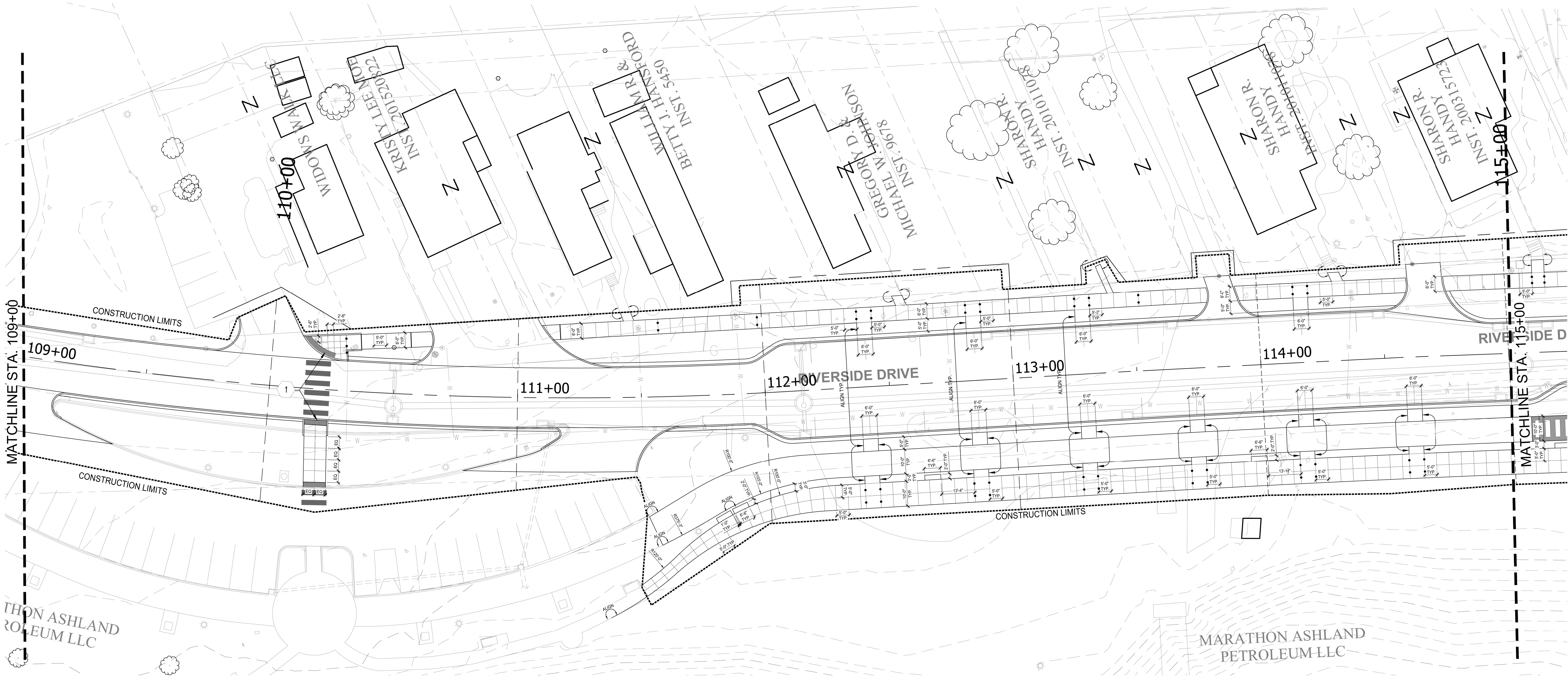

LAYOUT LEGEND



ALIGN



CONSTRUCTION JOINT
SEE DETAIL 2, SHEET LZ 5.0



CONTROL JOINT
SEE DETAIL 3, SHEET LZ 5.0

CODED NOTES

- 1 REFER TO CIVIL SHEETS FOR CURB RAMP LAYOUT.

LAYOUT NOTES

- ALL DIMENSIONS SHOWN ARE IN FEET AND INCHES UNLESS OTHERWISE NOTED.
- DO NOT SCALE DRAWINGS. UTILIZE DIMENSIONS INDICATED ON THE PLANS.
- ALL DIMENSIONS ARE TO THE EDGE OF PAVEMENT, FACE OF WALL, OR FACE OF CURB UNLESS OTHERWISE NOTED.
- WALKWAYS AND HARDSCAPE ELEMENTS INDICATED AS CURVILINEAR SHALL HAVE SMOOTH CONTINUOUS CURVES.
- UNLESS INDICATED OTHERWISE, ALL WALKWAYS ABUTT AT 90 DEGREE ANGLES.
- ALL CONCRETE SCORING SHALL BE PARALLEL, PERPENDICULAR OR TANGENT TO ADJACENT IMPROVEMENTS UNLESS OTHERWISE NOTED.
- LAYOUT ALL CONSTRUCTION LINES AND VERIFY LAYOUT WITH THE OWNER'S REPRESENTATIVE PRIOR TO BEGINNING ANY CONSTRUCTION WORK.
- PROVIDE ISOLATION JOINTS WHERE CONCRETE PAVING OR PAVING BASE MEETS A FIXED STRUCTURE (EXISTING OR PROPOSED).
- PROVIDE FLUSH CONDITIONS AT JUNCTURE OF ALL WALKWAYS AND DOOR THRESHOLDS.

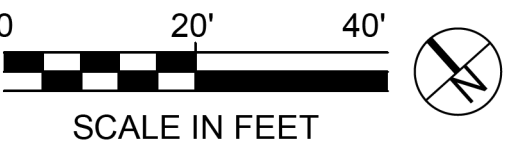

MKSK

200 SOUTH MERIDIAN STREET, SUITE 450
INDIANAPOLIS, IN 46225
PHONE: (317) 423-9600

NOT FOR
CONSTRUCTION

RECOMMENDED FOR APPROVAL		X/XX/XXXX DATE	
DESIGN ENGINEER			
DESIGNED:	EL 3/19/2020	DRAWN:	JD 2/21/2020
CHECKED:	MB 2/21/2020	CHECKED:	MB 2/21/2020

TOWN OF CLARKSVILLE

LL 4.1 - LAYOUT PLAN

HORIZONTAL SCALE	BRIDGE FILE	
1" = 20'	N/A	
VERTICAL SCALE	DESIGNATION	
N/A	1700725	
SURVEY BOOK	SHEETS	
Electronic	38	of 83
CONTRACT	PROJECT	
R-40289	1700725	

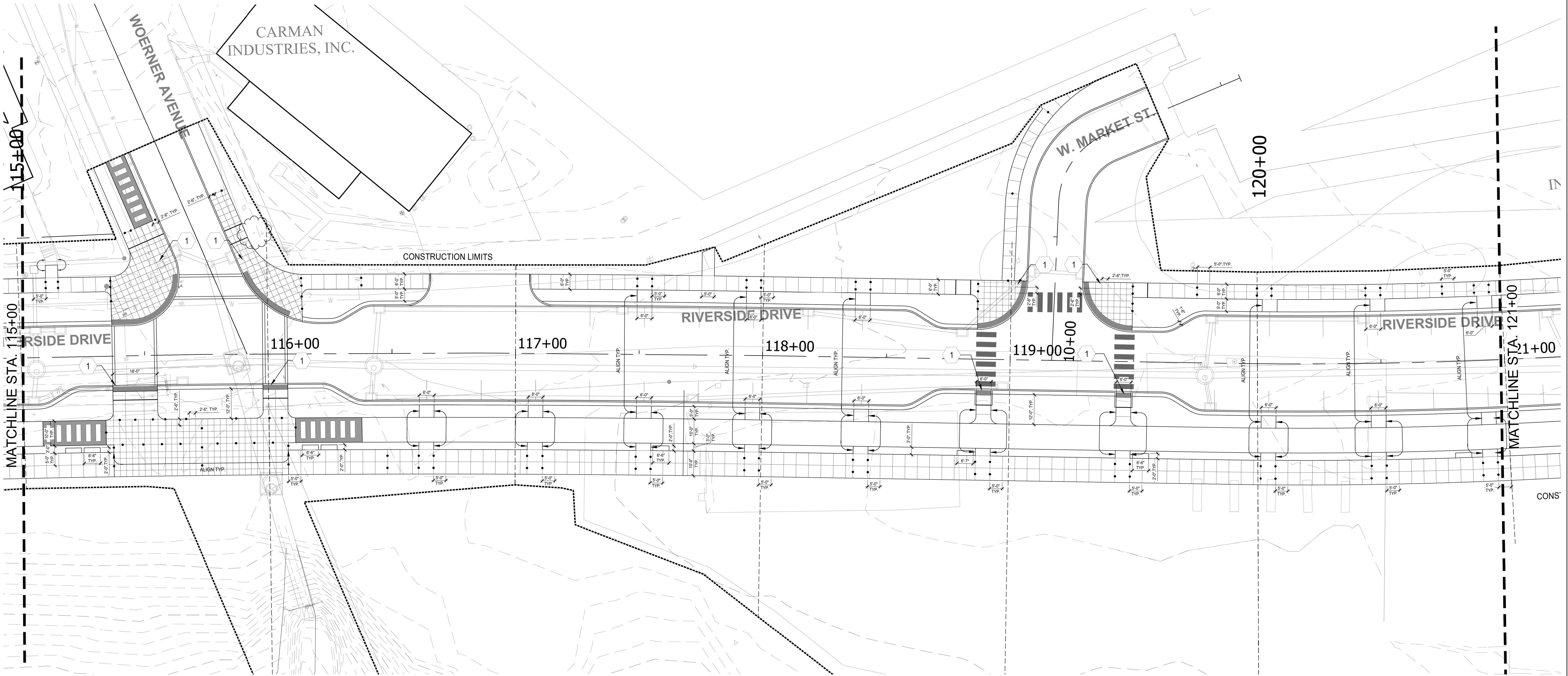

LAYOUT LEGEND



ALIGN



CONSTRUCTION JOINT
SEE DETAIL 2, SHEET LZ 5.0



CONTROL JOINT
SEE DETAIL 3, SHEET LZ 5.0

CODED NOTES

- 1 REFER TO CIVIL SHEETS FOR CURB RAMP LAYOUT.

LAYOUT NOTES

- ALL DIMENSIONS SHOWN ARE IN FEET AND INCHES UNLESS OTHERWISE NOTED.
- DO NOT SCALE DRAWINGS. UTILIZE DIMENSIONS INDICATED ON THE PLANS.
- ALL DIMENSIONS ARE TO THE EDGE OF PAVEMENT, FACE OF WALL, OR FACE OF CURB UNLESS OTHERWISE NOTED.
- WALKWAYS AND HARDSCAPE ELEMENTS INDICATED AS CURVILINEAR SHALL HAVE SMOOTH CONTINUOUS CURVES.
- UNLESS INDICATED OTHERWISE, ALL WALKWAYS ABUTT AT 90 DEGREE ANGLES.
- ALL CONCRETE SCORING SHALL BE PARALLEL, PERPENDICULAR OR TANGENT TO ADJACENT IMPROVEMENTS UNLESS OTHERWISE NOTED.
- LAYOUT ALL CONSTRUCTION LINES AND VERIFY LAYOUT WITH THE OWNER'S REPRESENTATIVE PRIOR TO BEGINNING ANY CONSTRUCTION WORK.
- PROVIDE ISOLATION JOINTS WHERE CONCRETE PAVING OR PAVING BASE MEETS A FIXED STRUCTURE (EXISTING OR PROPOSED).
- PROVIDE FLUSH CONDITIONS AT JUNCTURE OF ALL WALKWAYS AND DOOR THRESHOLDS.

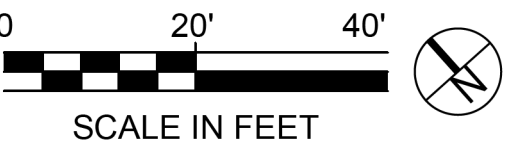

MKSK

200 SOUTH MERIDIAN STREET, SUITE 450
INDIANAPOLIS, IN 46225
PHONE: (317) 423-9600

NOT FOR
CONSTRUCTION

RECOMMENDED FOR APPROVAL		X/XX/XXXX DATE	
DESIGN ENGINEER			
DESIGNED:	EL 3/19/2020	DRAWN:	JD 2/21/2020
CHECKED:	MB 2/21/2020	CHECKED:	MB 2/21/2020

TOWN OF CLARKSVILLE

LL 4.2 - LAYOUT PLAN

HORIZONTAL SCALE	BRIDGE FILE	
1" = 20'	N/A	
VERTICAL SCALE	DESIGNATION	
N/A	1700725	
SURVEY BOOK	SHEETS	
Electronic	39	of 83
CONTRACT	PROJECT	
R-40289	1700725	

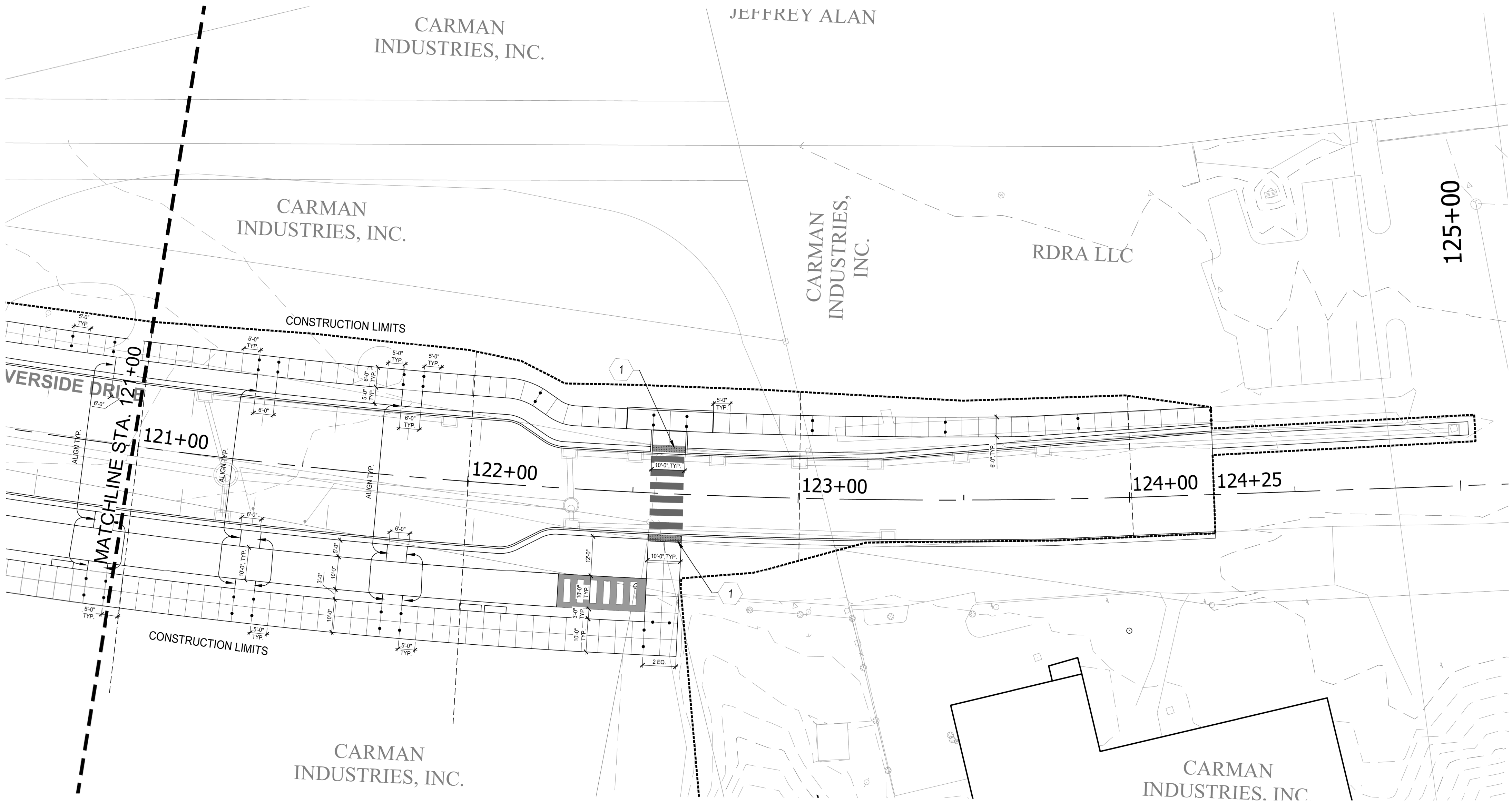

LAYOUT LEGEND



ALIGN



CONSTRUCTION JOINT
SEE DETAIL 2, SHEET LZ 5.0



CONTROL JOINT
SEE DETAIL 3, SHEET LZ 5.0

CODED NOTES

1 REFER TO CIVIL SHEETS FOR CURB RAMP LAYOUT.

LAYOUT NOTES

- ALL DIMENSIONS SHOWN ARE IN FEET AND INCHES UNLESS OTHERWISE NOTED.
- DO NOT SCALE DRAWINGS. UTILIZE DIMENSIONS INDICATED ON THE PLANS.
- ALL DIMENSIONS ARE TO THE EDGE OF PAVEMENT, FACE OF WALL, OR FACE OF CURB UNLESS OTHERWISE NOTED.
- WALKWAYS AND HARDSCAPE ELEMENTS INDICATED AS CURVILINEAR SHALL HAVE SMOOTH CONTINUOUS CURVES.
- UNLESS INDICATED OTHERWISE, ALL WALKWAYS ABUTT AT 90 DEGREE ANGLES.
- ALL CONCRETE SCORING SHALL BE PARALLEL, PERPENDICULAR OR TANGENT TO ADJACENT IMPROVEMENTS UNLESS OTHERWISE NOTED.
- LAYOUT ALL CONSTRUCTION LINES AND VERIFY LAYOUT WITH THE OWNER'S REPRESENTATIVE PRIOR TO BEGINNING ANY CONSTRUCTION WORK.
- PROVIDE ISOLATION JOINTS WHERE CONCRETE PAVING OR PAVING BASE MEETS A FIXED STRUCTURE (EXISTING OR PROPOSED).
- PROVIDE FLUSH CONDITIONS AT JUNCTURE OF ALL WALKWAYS AND DOOR THRESHOLDS.

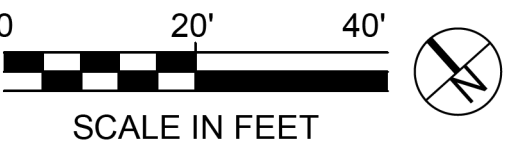

MKSK

200 SOUTH MERIDIAN STREET, SUITE 450
INDIANAPOLIS, IN 46225
PHONE: (317) 423-9600

NOT FOR
CONSTRUCTION

RECOMMENDED FOR APPROVAL _____		X/XX/XXXX DATE	
DESIGNED: EL 3/19/2020		DRAWN: JD 2/21/2020	
CHECKED: MB 2/21/2020		CHECKED: MB 2/21/2020	

TOWN OF CLARKSVILLE

LL 4.3 - LAYOUT PLAN

HORIZONTAL SCALE	BRIDGE FILE	
1" = 20'	N/A	
VERTICAL SCALE	DESIGNATION	
N/A	1700725	
SURVEY BOOK	SHEETS	
Electronic	40	of 83
CONTRACT	PROJECT	
R-40289	1700725	